

SCHOOL DISTRICT NO. 57 (PRINCE GEORGE)

March 3, 2017

MEMORANDUM

TO: Board of Education

FROM: Superintendent of Schools  
Secretary Treasurer

SUBJECT: REOPEN SPRINGWOOD ELEMENTARY SCHOOL

---

RECOMMENDATIONS

1. THAT Springwood Elementary School, Facility Number 57089, located at 4600 Zral Road, Prince George, B.C., be reopened effective September 1, 2017 as an elementary school enrolling students in Grades Kindergarten to 7.
2. THAT the catchment area for Springwood Elementary School, and the revised catchment areas for Heather Park Elementary School, and Glenview Elementary School, attached as Appendix A, B, and C, be approved.
3. THAT students currently enrolled in Grade 6 in the proposed new catchment area for Springwood Elementary School be permitted to remain at their current school for Grade 7.
4. THAT a Student Transfer Process specific to the reopening of Springwood Elementary, in accordance with Policy 5119 School Catchment Areas, Registration and Student Transfer, be set from April 9 to 21, 2017.

\*\*\*\*\*

BACKGROUND

1. The enrollment at Heather Park Elementary School, Hart Highlands Elementary School, and Glenview Elementary School is projected to be near or at operating and nominal capacity for September 2017.

2. The November 10, 2016 Supreme Court of Canada decision and negotiations between the Government of British Columbia and the BC Teachers' Federation has determined that class sizes be returned to those class sizes that were in place in 2002.
3. The organization of these three elementary schools, in accordance with the 2002 class size language, is estimated to require ten additional classrooms.
4. Springwood Elementary School was closed effective September 1, 2010.
5. Reopening Springwood Elementary School and establishing a catchment area for this school, and revising the catchment areas for Heather Park Elementary School and Glenview Elementary School, will provide the additional classrooms required in this area of the school district.
6. Section 75.1 of the *School Act* provides that a Board must establish for each school in its school district, a catchment area consisting of a geographical area around the school that includes all or part of the school district. This section further provides that a Board may amend the catchment area established for a school.
7. Section 73 of the *School Act* provides that a Board may, subject to the orders of the minister reopen a school permanently.
8. Policy 5119, School Catchment Areas, Registration and Student Transfer, Administration Procedure 4.1 requires that annually, the total enrolment and/or program enrolment capacity within each school will be determined by the Superintendent of Schools.
9. Policy 7550 Opening and Closing of Schools, and Ministerial Order 194/08 School Opening and Closure Order both require that if a Board decides to reopen a previously closed school the Board will provide without delay, written notification to the Minister of Education of the decision and include the following information:
  - o The name of the school.
  - o The facility number of the school.
  - o The address of the school.
  - o The date the school will open or reopen.

CO/dln

Re-open Springwood Elementary

**Appendix A: Proposed Springwood Elementary Catchment**

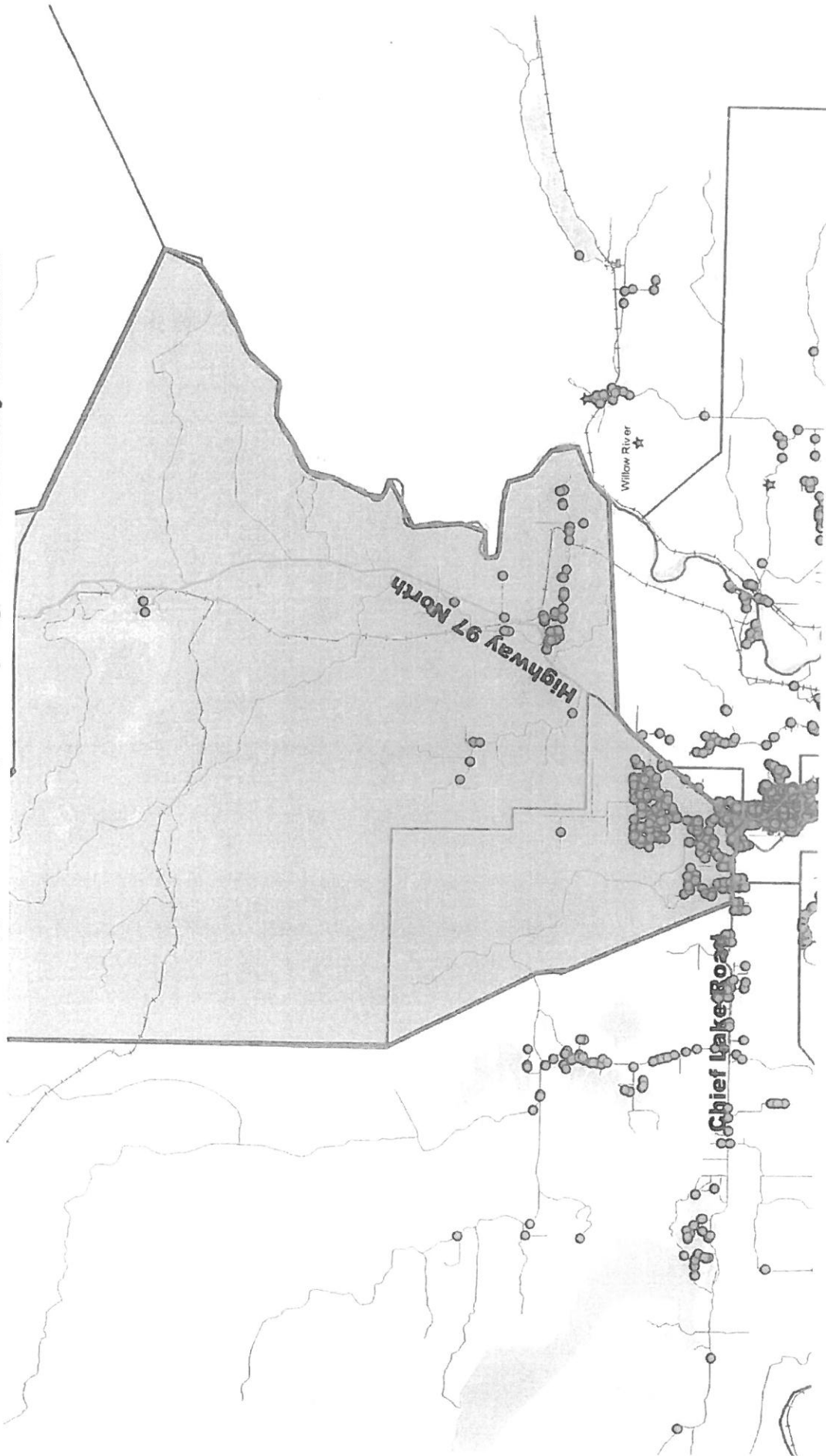

**Appendix B: Proposed Heather Park Elementary Catchment**

Heather Park

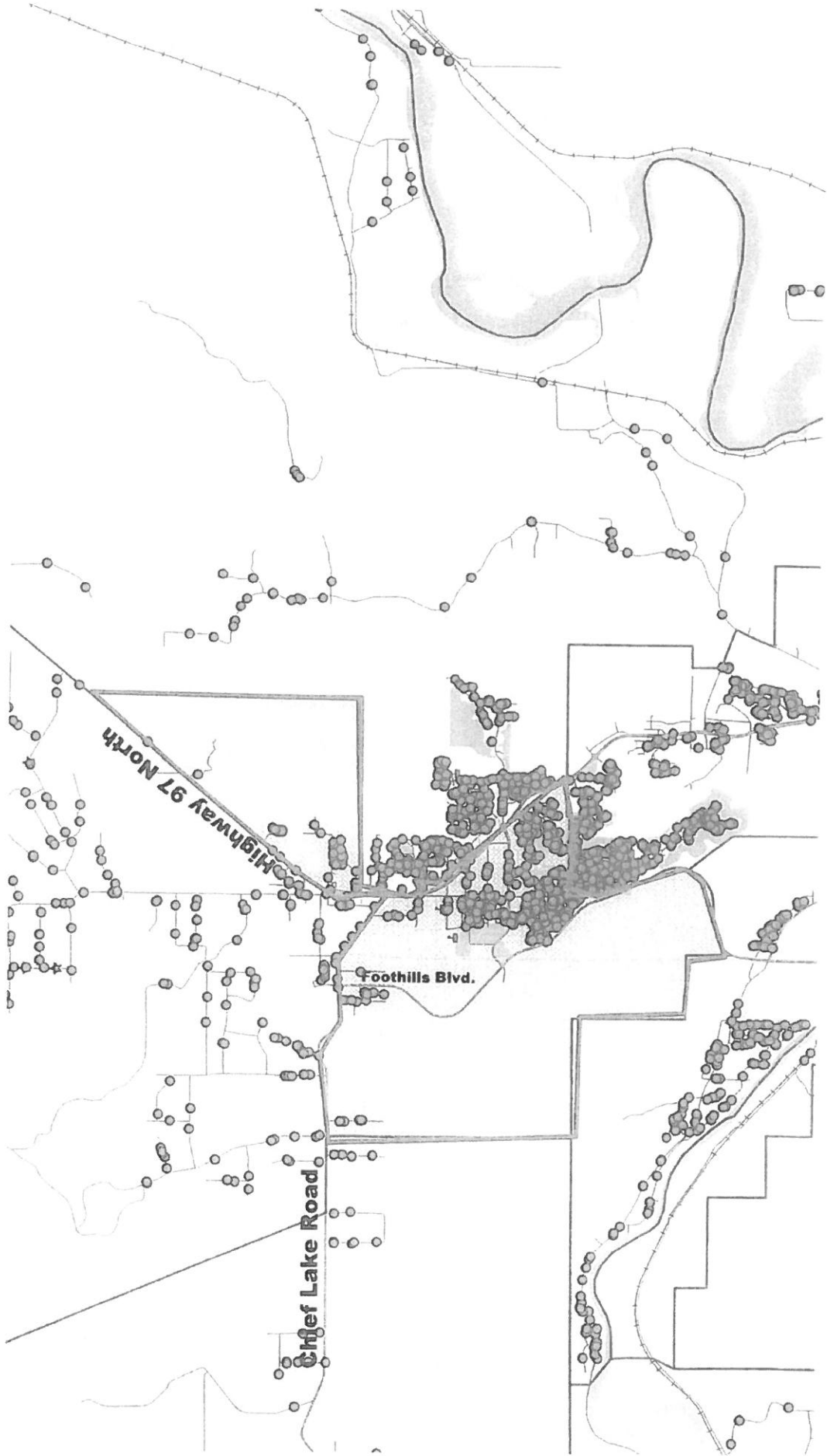

**Appendix C: Proposed Glenview Elementary Catchment**

